

MOTOARE electrice

POMPE industriale

ETANȘĂRI mecanice



+40 264 274578

office@pro-tehnic.ro

+40 264 274577

www.pro-tehnic.ro

Str. Rozmarinului f.n., 400426 Cluj-Napoca, ROMÂNIA

Three phase squirrel cage rotor induction motor

DATA SHEET

1 Model : 2MSE-112M-2
2 Rated power : 4KW
3 Rated voltage : 230/400 V
4 Phase: 3
5 Rated frequency : 50HZ
6 Pole : 2 pole
7 Rated current : 7,98 A
8 Rated speed: 2850 R/min.
9 Synchronous rotation speed : 3000 R/min
10 Efficiency : 84.5%
11 Power factor : 0,87
12 Locked-rotor current/rated current : 7.0
13 Locked-rotor torque/rated torque : 2,0
14 Breakdown torque/rated torque : 2.0
15 Protection class : IP55
16 Cooling type : IC411
17 Insulation class : F
18 Duty : S1
19 Stator connection type : Δ / Y
20 Mounting type : IM B3
21 The rotation direction of the motor : Bi-directional rotation
22 Bearing type on driving end: 6306 2RS C3
23 Bearing type on non-driving end: 6306 2RS C3
24 Terminal dimension : M25 \times 12,5MM
25 Motor color : Blue , RAL 5010.
26 Weight roughly: 26,0 kg
27 Frame: Aluminium

MOTOARE electrice

POMPE industriale

ETANȘĂRI mecanice



+40 264 274578

office@pro-tehnic.ro

+40 264 274577

www.pro-tehnic.ro

Str. Rozmarinului f.n., 400426 Cluj-Napoca, ROMÂNIA

CONSTRUCTIVE FORM B3

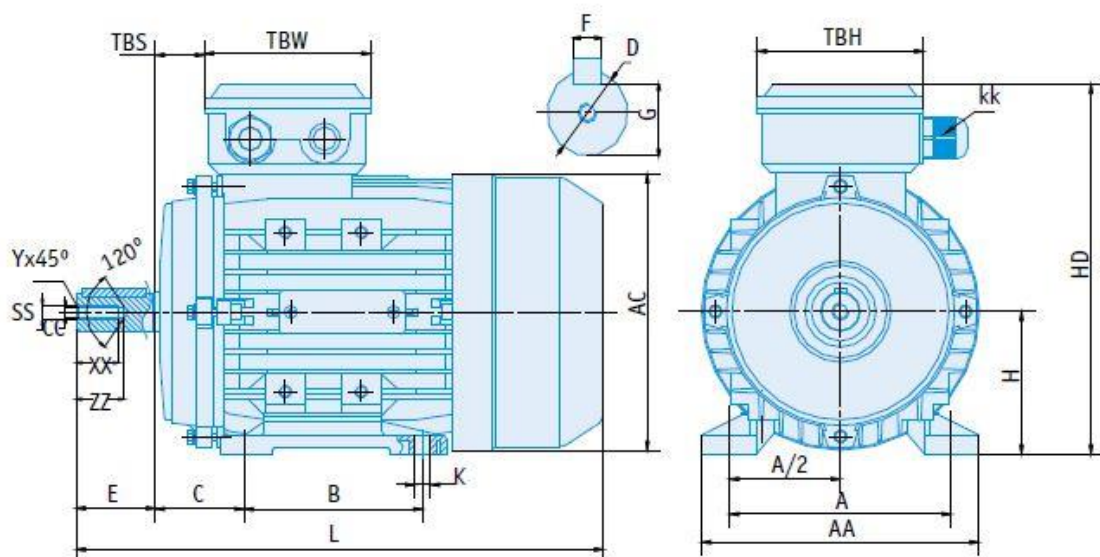

Type motor B3	A	AA	AC	B	C	H	HD	L	D	E	F	G	SS	XX	ZZ
2MSE-112M-2 4kw/3000rpm	190	220	229	140	70	112	282	400	28	60	8	24	M10	22	30

